

## CUSTOM LINE NAVETTA 30



### “CHECKMATE”

Semi displacement, as new, delivered summer 2022 and absolutely fully equipped.

|             |   |                              |
|-------------|---|------------------------------|
| YEAR        | : | 2022                         |
| L.O.A.      | : | 28.43m                       |
| LENGTH HULL | : | 23.98 m                      |
| BEAM        | : | 7.31m                        |
| DRAFT       | : | 2.20m                        |
| WEIGHT      | : | 115 t empty and 135 t loaded |
| DIESEL      | : | 14.500 litres                |
| WATER       | : | 2.500 litres                 |
| ENGINES     | : | MAN V8 1000 hp               |
| HOURS       | : | 350 hrs                      |
| FLAG        | : | British, Jersey              |
| LYING       | : | Mallorca, Spain              |
| PRICE       | : | €10.700.000 (VAT not paid)   |

All particulars are believed to be correct, but not guaranteed.

## CUSTOM LINE NAVETTA 30

Exterior design: Filippo Salvetti Design  
Interior: Citterio – Viel & Partners

### SPEEDS AND RANGE:

|                         |  |
|-------------------------|--|
| Top Speed               | 15 knots (1/3 load on acceptance trials) |
| Cruise Speed            | 13 knots (1/3 load on acceptance trials) |
| Economical cruise speed | 10 knots                                 |
| Range at 13 knots       | 850 miles                                |
| Range at 10 knots       | 2,000 nautical miles                     |

### LAYOUT:

|                     |   |
|---------------------|---|
| Guest Accommodation | 11 beds in 5 cabins – 1 x Main Deck Master, 2 x Lower Deck Twin (Port with pullman berth) & 2 x Lower Deck Double |
| Crew Accommodation  | 5 beds in 3 cabins - 1 x Captain's Cabin, 2 x Twin bunk cabins  |

### NAVIGATION:

Super premium integrated bridge upgrade – 6 monitors for navigation  
Telecamera Flir night vision  
Autopilot  
Radio VHF x 2  
CCTV system and cameras  
Depth / speed / wind / compass / ruddwer position / monitoring system  
Radar Antenna HALO 6ft  
GPS antenna 3  
Weather station Ultrasonic NMEA  
Elecgtronic engine controls  
2 wing stations for boats manoevering

All particulars are believed to be correct, but not guaranteed.

## CUSTOM LINE NAVETTA 30

### STABILIZERS:

Fin stabilizers ABT TRAC and zero speed gyro Seakeeper

### TENDER:

Williams 435 TurboJet

### EQUIPMENT interior:

Super Tropical Air Conditioning

2 generators of 28 KW Kohler

Pullman bed in the portside guest cabin

Single beds that could be joined to be used as king size bed in the starboard side guest cabin

Dimmer lights for interiors

Phone system in all boat

Electrochromic LCD glass between UD salon and pilothouse

Package premium internet

Electrical raising of curtains in main deck

Electrical raising of curtains in lower deck (4 cabins)

Electrical raising of curtains in upper deck salon

Automatic opening aft glass door in main deck salon

Automatic opening for glass aft door in upper salon (1 panel) upgrade

Lateral door on salon starboard side - manual opening

Lateral door on salon portside - manual opening

MD Wood floor galley excluded) American walnut carbonio 349E

UD wood floor American walnut carbonio 349E

Fuel Oil filling station In garage for tender

Automatic battery charger on generators

Treatment system for black / gray water Hamann

Watermaker: Idromar 500 l/h (duplex 250 + 250 l/h) upgrade

Fire pump Gianneschi

230V / 400V AC 50HZ shore power

Automatic battery chargers and inverters

All particulars are believed to be correct, but not guaranteed.

## CUSTOM LINE NAVETTA 30

### EQUIPMENT exterior:

Teak floor with black caulking on sun deck and forward triangle area  
Hydraulic pasarelle  
Underwater lights: 3 each side, 2 at stern  
Bow thruster 50 hp hydraulic  
Stern thruster 30 hp hydraulic double propeller  
2 anchor winches 3500 W with 13mm 120 m chain and 120 kg anchor  
2 stern mooring winches  
Aft garage door converting to swim platform and shower at stern  
Travel lift in garage ceiling for launch and hauling of jet ski  
Bimini for dinette at bow (manual)  
Safety equipment, life rings, life jackets, kit buoy, first aid kit...

### AUDIO VISUAL:

Antenna TV SAT KVH HD8 with receiver in salon and empty dome  
ALL-IN-ONE remote audio-video control with Apple iPad  
Home theatre system with amplifier tuner connected to central server unit and Apple TV in main saloon, upper deck saloon and main cabin  
Sound system in galley and cabins and exterior sound all decks  
TV 55" LCD/LED thin with electric raising device in Main Deck salon  
TV 55" with up & down movement system in UD salon bow wall  
TV Samsung 55" in master cabin, TV in galley and cabins

### DOMESTIC:

Miele appliances upgrade in the galley  
Ceramic 5 burner, Oven 90 cm, Dishwasher, Fridge freezer, Trash compactor  
Wine cooler Miele 16 bottles  
Drawer fridge for bottles in sun deck  
Professional icemaker in pantry main deck  
Icemaker in UD salon  
Grill on wet bar upper deck  
Washer and drier Miele (separate units)

All particulars are believed to be correct, but not guaranteed.

# CUSTOM LINE NAVETTA 30

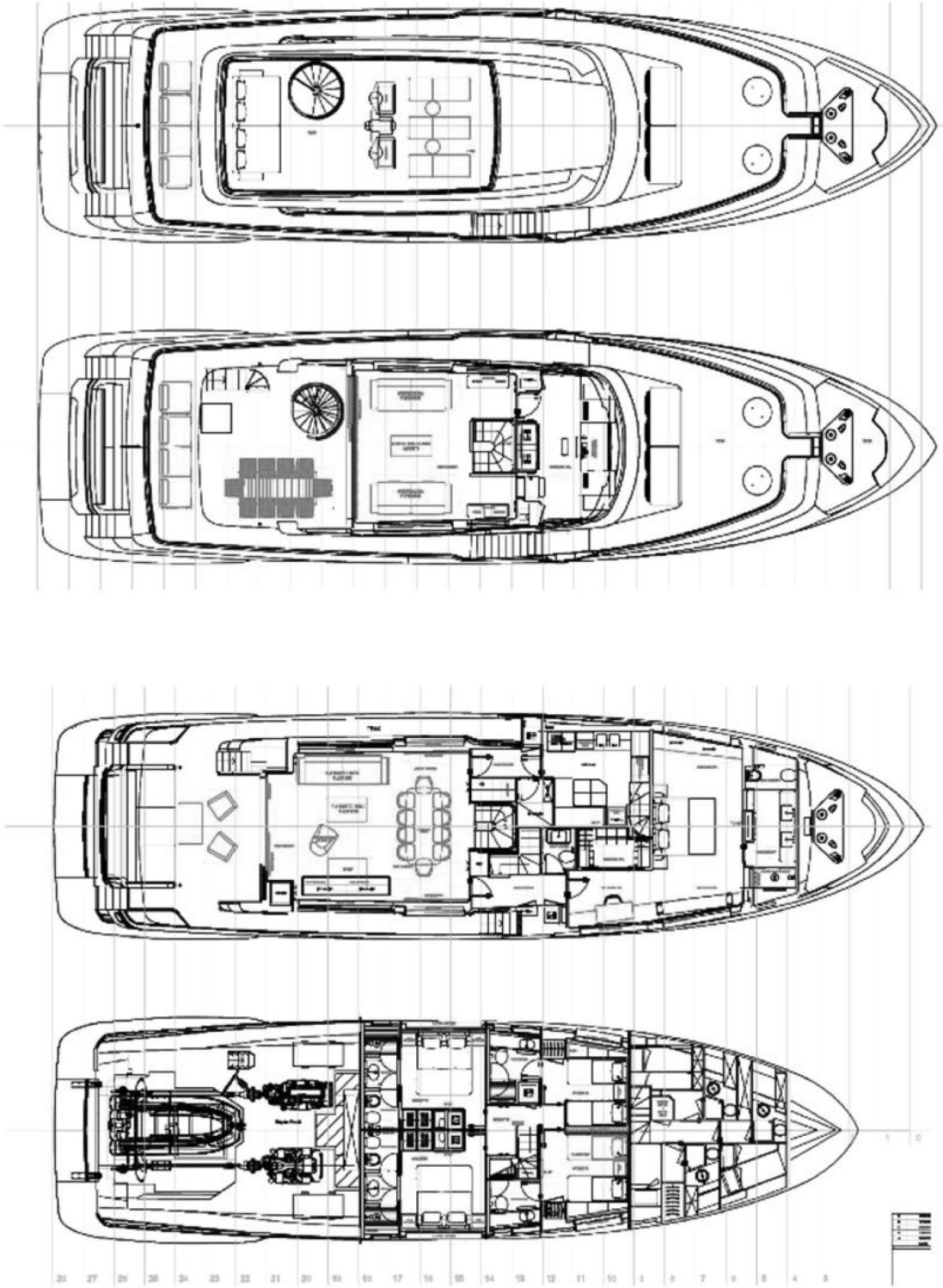

All particulars are believed to be correct, but not guaranteed.